

Parts List

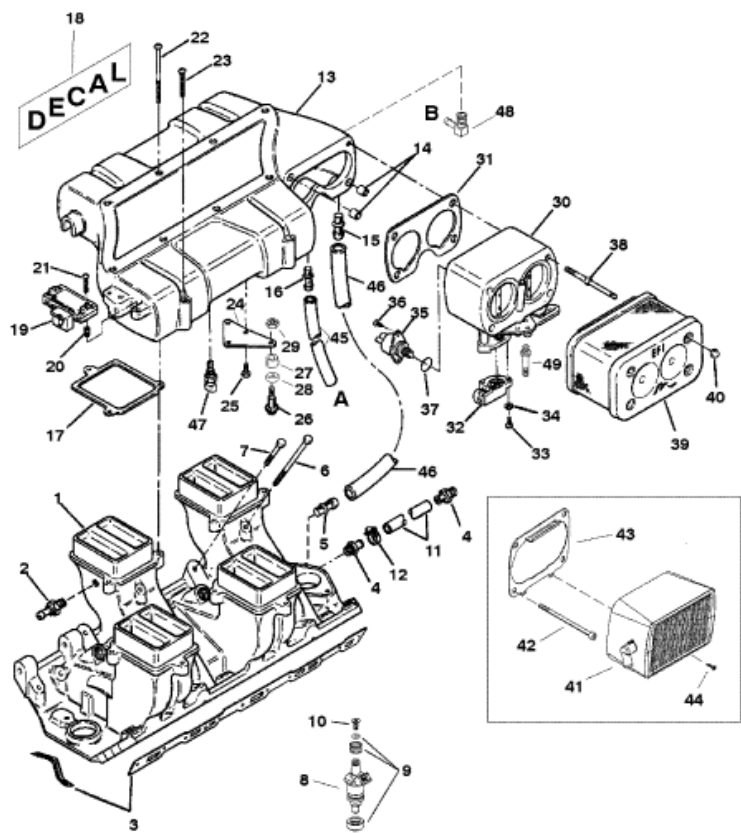

A = TO FUEL PRESSURE REGULATOR  
 B = TO PCV VALVE

Ref	Class	Part	Description	Qty	Comment	Footnote
1		805233A 2	MANIFOLD ASSEMBLY-INTAKE	1		
2	22	805691	FITTING (1/4 IN. BARB)	1		
3	27	805403A 1	GASKET SET	1		3,4
4	22	806242	CONNECTOR	2		
5	22	805519	FITTING (1/4 IN. BARB)	1		
6	10	807640	SCREW (3/8-16 X 5-1/2 IN.)	4		
7	10	807641	SCREW (3/8-16 X 1-3/4 IN.)	12		
8		805225A 1	INJECTOR-FUEL	8		
9	25	805511A 1	O-RING KIT	8		3,4
10	35	17422	FILTER	8		
11	32	805987 1	HOSE-BYPASS	1		
12	54	815504212	CLAMP-HOSE	2		
13		805240A 1	PLENUM-INTAKE	1		
14	23	52698	SLEEVE	2		
15	22	805519	FITTING (1/4 IN. BARB)	1		
16	22	805598	FITTING (3/16 IN. BARB)	1		
17	27	805522A 1	GASKET SET	1		3,4
18	37	823816 13	DECAL	1	(7.4L)	
18	37	823816 14	DECAL	1	(8.2L)	
19		805217A 1	SENSOR-MAP	1		
20	26	805412	SEAL	1		3,4
21	10	807120	SCREW (#10-24 X 1 IN.)	2		
22	10	805391	SCREW (5/16-18 X 4-1/2 IN.)	8		
23	10	805390	SCREW (5/16-18 X 2-1/4 IN.)	4		
24		805413T	BRACKET-THROTTLE CABLE	1		
25	10	73286	SCREW (1/4-20 X 1/2 IN.)	3		
26	10	807132	BOLT-SHOULDER	1		
27	23	11284	SPACER	1		
28	12	26825	WASHER	1		
29	11	814101	NUT (1/4-20)	1		
30		805243A12	THROTTLE BODY	1	(VST FUEL SYSTEM)	
30		860204A 5	THROTTLE BODY	1	(FUEL COOLED SYSTEM)	
31	27	805396	GASKET-THROTTLE BODY	1		3,4
32		805226A 1	SENSOR-TPS	1		
33	10	805400	SCREW (#8-32 X 1/2 IN.)	2		
34	12	28001	WASHER	2		
35		805224A 1	IAC MOTOR	1		
36	10	805400	SCREW (#8-32 X 1/2 IN.)	2		
37	25	808547	O-RING	1		
38	16	805399	STUD	4	METAL FLAME ARRESTOR	
39		805401A 2	FLAME ARRESTOR	1	METAL FLAME ARRESTOR	