

9
GASKET SET

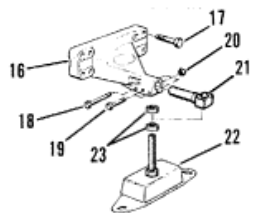

Parts List						
Ref	Class	Part	Description	Qty	Comment	Footnote
2	882	801763685	CYLINDER BLOCK	AR	QUANTITIES: (5 CYL) - 1; (6 CYL)	
2	882	801331600	CYLINDER BLOCK	AR	QUANTITIES: (5 CYL) - 0; (6 CYL)	
3	19	801331602	EXPANSION PLUG	AR	QUANTITIES: (5 CYL) - 2; (6 CYL)	
4	19	809937241	EXPANSION PLUG	AR	QUANTITIES: (5 CYL) - 2; (6 CYL)	
5	10	801331604	BOLT	AR	QUANTITIES: (5 CYL) - 2; (6 CYL)	
6		801761848	ANGLE SUPPORT/LIFTING EYE	AR	QUANTITIES: (5 CYL) - 5; (6 CYL)	
7	13	809931076	LOCKWASHER	AR	QUANTITIES: (5 CYL) - 1; (6 CYL)	
8	10	809919933	SCREW	AR	QUANTITIES: (5 CYL) - 1; (6 CYL)	
9	27	822567A 1	GASKET SET	AR	QUANTITIES: (5 CYL) - 1; (6 CYL)	
9	27	822570A 1	GASKET SET	AR	QUANTITIES: (5 CYL) - 0; (6 CYL)	
10	10	801331650	LOCATING SCREW	AR	QUANTITIES: (5 CYL) - 3; (6 CYL)	
10	10	801331650	LOCATING SCREW	AR	QUANTITIES: (5 CYL) - 4; (6 CYL)	
11	12	809963201	WASHER	AR	QUANTITIES: (5 CYL) - 4; (6 CYL)	1,3
11	12	809963201	WASHER	AR	QUANTITIES: (5 CYL) - 4; (6 CYL)	1,3
12		801763387	NOZZLE	AR	QUANTITIES: (5 CYL) - 1; (6 CYL)	
13	22	801331684	DRAIN COCK	AR	QUANTITIES: (5 CYL) - 1; (6 CYL)	
14	22	801763388	CONNECTOR	AR	QUANTITIES: (5 CYL) - 1; (6 CYL)	
15	12	809963072	WASHER	AR	QUANTITIES: (5 CYL) - 1; (6 CYL)	
16		801761382	MOUNTING BRACKET	AR	QUANTITIES: (5 CYL) - 2; (6 CYL)	
17	10	809913859	SCREW	AR	QUANTITIES: (5 CYL) - 8; (6 CYL)	
18	10	809912516	SCREW	AR	QUANTITIES: (5 CYL) - 4; (6 CYL)	
19	10	801761617	SCREW	AR	QUANTITIES: (5 CYL) - 2; (6 CYL)	
20	11	809922426	NUT	AR	QUANTITIES: (5 CYL) - 4; (6 CYL)	
21		801763304	PIN	AR	QUANTITIES: (5 CYL) - 2; (6 CYL)	
22		801763875	MOUNT	AR	QUANTITIES: (5 CYL) - 2; (6 CYL)	
23	11	809922457	NUT	AR	QUANTITIES: (5 CYL) - 4; (6 CYL)	
24	87	801331979	OIL PRESSURE SENDER	AR	QUANTITIES: (5 CYL) - 1; (6 CYL)	
25	16	801763908	STUD	AR	QUANTITIES: (5 CYL) - 2; (6 CYL)	