

(ALL 305 CID)(350 CID - ALL 5.7L ALPHA)
 (350MAG/5.7L BRAVO -S/N-0D617327 & BELOW)

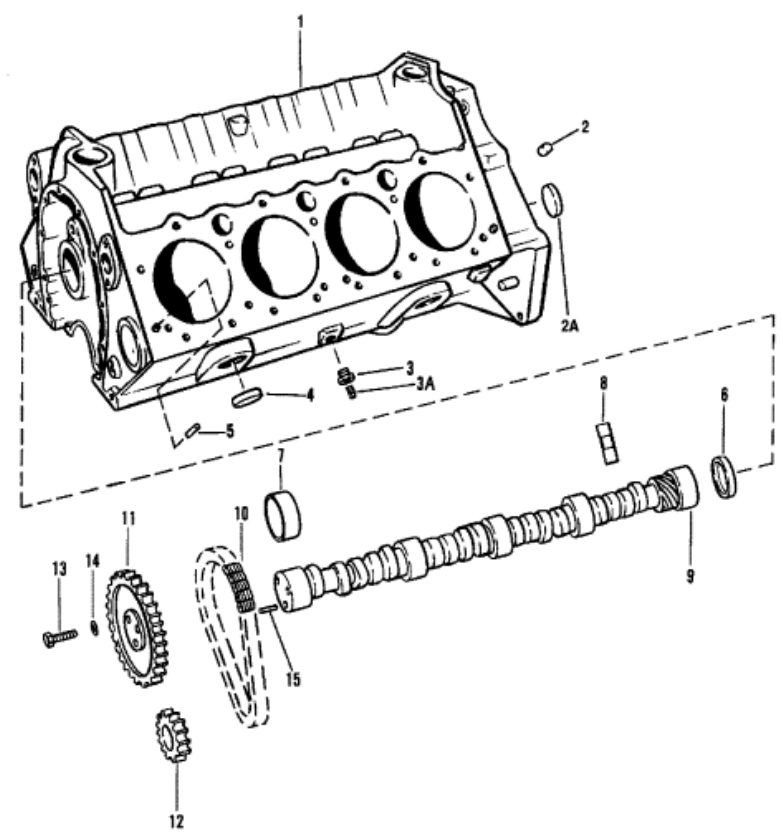

| Parts List | | | | | | |
|------------|-------|----------|-------------------------------|----------------------------|------------------------------|--------------|
| Ref | Class | Part | Description | Qty | Comment | Footnote |
| 1 | | N.S.S. | CYLINDER BLOCK ASSEMBLY | 1 | (305 C.I.D.) (ORDER REMANUFA | 2 |
| 1 | | N.S.S. | CYLINDER BLOCK ASSEMBLY | 1 | (350 C.I.D.) (ORDER REMANUFA | 2 |
| 2 | 22 | 48340 | PIPE PLUG (1/4 IN.) | 3 | | |
| 2A | 19 | 816565 | EXPANSION PLUG (15/32 IN.) | 5 | | |
| 3 | 22 | 48556 | BUSHING | 2 | | |
| 3A | 22 | 32802 | PIPE PLUG | 2 | | |
| 4 | 19 | 34270 | EXPANSION PLUG (1-5/8 IN. DI. | 8 | | |
| 5 | 17 | 35465 | DOWEL PIN (5/16 IN. DIA.) | 4 | | |
| 6 | 22 | 72640 | PLUG | 1 | | |
| 7 | 23 | 85674 | BEARING UNIT (SET) | 1 | | |
| 8 | | 72638 | LIFTER | 16 | | |
| 9 | 431 | 5943 | CAMSHAFT | 1 | | |
| 10 | | 17161 | CHAIN | 1 | | |
| 11 | 43 | 17159 | SPROCKET | 1 | | |
| 12 | 43 | 17160 | SPROCKET | 1 | | |
| 13 | 10 | 34505 | BOLT (3/4 IN.) | 3 | | |
| 14 | 12 | 848136 | WASHER | 3 | | |
| 15 | 17 | 35312 | PIN | 1 | | |
| - | | 805636R | 2 | REMANUFACTURED MARINE LO | 1 | (305 C.I.D.) |
| - | | 14152R | 2 | REMANUFACTURED MARINE LO | 1 | (350 C.I.D.) |
| - | 27 | 75611A88 | ENGINE OVERHAUL GASKET SE | 1 | | |
| - | 92 | 91601 | SEALER-RED RTV (WHERE APPL | 1 | | |
| - | 92 | 34227 | 1 | PERFECT SEAL (WHERE APPLIC | 1 | |