

INBOARD

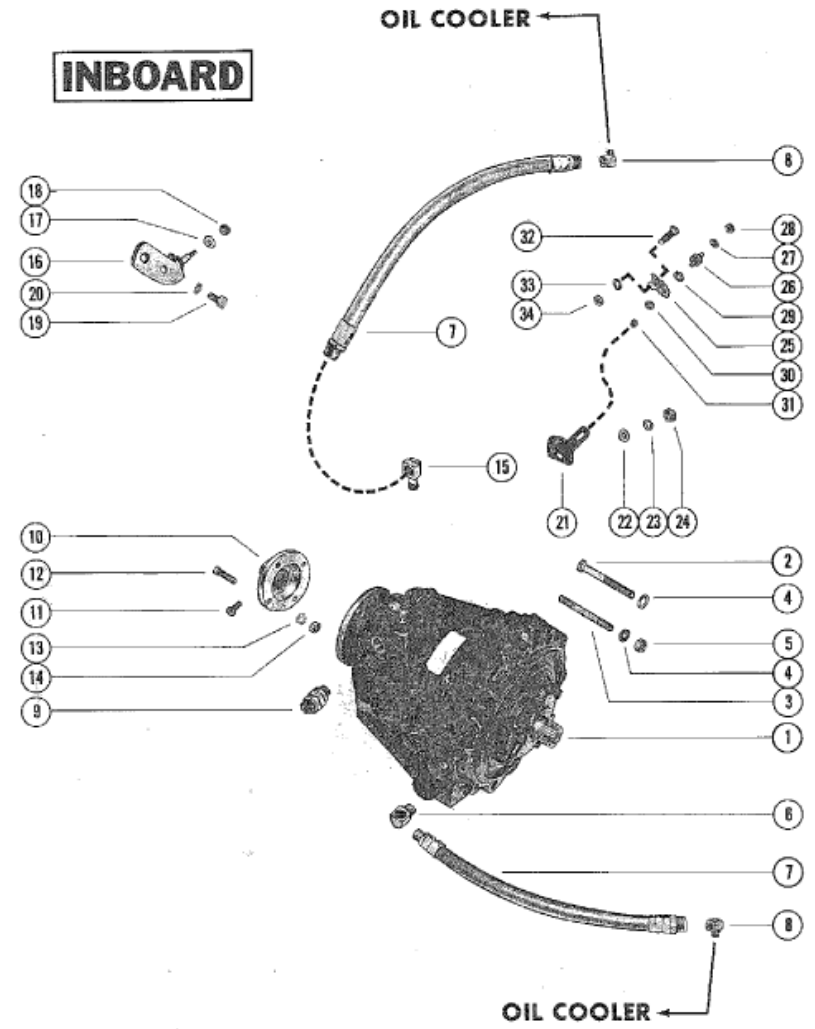

| Parts List | | | | | | |
|------------|-------|----------|------------------------------|----------|------------------|----------|
| Ref | Class | Part | Description | Qty | Comment | Footnote |
| 1 | | 47805 | TRANSMISSION (DIRECT DRIVE) | 1,... | | |
| 1 | | 47806 | TRANSMISSION (1.523:1 REDUC | ,1,... | | |
| 1 | | 47807 | TRANSMISSION (1.909:1 REDUC | ,,1,... | | |
| 1 | | 47808 | TRANSMISSION (2.57:1 REDUCT | ,,,1, | | |
| 1 | | 47809 | TRANSMISSION (2.909:1 REDUC | ,,,,1 | | |
| 2 | 10 | 47724 | SCREW, TRANSMISSION TO ENI | 4,... | | |
| 2 | 10 | 47724 | SCREW, TRANSMISSION TO ENI | ,6,6,6,E | | |
| 3 | 16 | 57921 | STUD, TRANSMISSION TO ENGI | 2,... | | |
| 4 | 13 | 32993 | LOCKWASHER, TRANSMISSION | 6,6,6,6, | | |
| 5 | 11 | 22024 | NUT, TRANSMISSION STUD | 2,... | | |
| 6 | 22 | 47629 | ELBOW, HOSE TO TRANSMISSIC | 1,1,1,1, | | |
| 7 | 32 | 47516 11 | HOSE, TRANSMISSION TO OIL C | 1,... | | |
| 7 | 32 | 47516 12 | HOSE, TRANSMISSION TO OIL C | ,1,1,1,1 | | |
| 7 | 32 | 47516 6 | HOSE, TRANSMISSION TO OIL C | 1,1,1,1, | | |
| 8 | 22 | 63835 | ELBOW, HOSE TO OIL COOLER | ,1,1,1,1 | | |
| 9 | | 47613 | SWITCH, NEUTRAL SAFETY | 1,1,1,1, | | |
| 10 | | 48381A 1 | FLANGE ASSEMBLY (1") | OPT,OI | SEE NOTE A | |
| 10 | | 48382A 1 | FLANGE ASSEMBLY (1 1/8") | OPT,OI | SEE NOTE A | |
| 10 | | 48383A 1 | FLANGE ASSEMBLY (1 1/4") | OPT,OI | SEE NOTE A | |
| 10 | | 48384A 1 | FLANGE ASSEMBLY (1 3/8") | OPT,OI | SEE NOTE A | |
| 10 | | 48385A 1 | FLANGE ASSEMBLY (1 1/2") | OPT,OI | SEE NOTE A | |
| 10 | | 48386A 1 | FLANGE ASSEMBLY (1") | ,,OPT, | SEE NOTE B | |
| 10 | | 48387A 1 | FLANGE ASSEMBLY (1 1/8") | ,,OPT, | SEE NOTE B | |
| 10 | | 48388A 1 | FLANGE ASSEMBLY (1 1/4") | ,,OPT, | SEE NOTE B | |
| 10 | | 48389A 1 | FLANGE ASSEMBLY (1 3/8") | ,,OPT, | SEE NOTE B | |
| 10 | | 48389A 1 | FLANGE ASSEMBLY (1 1/2") | ,,OPT, | SEE NOTE B | |
| 11 | 10 | 60168 | SCREW, FLANGE TO PROPELL | 2,2,2, | SEE NOTE A AND B | |
| 11 | 10 | 60171 | SREW,FLANGE TO PROPELL | ,,2,2 | SEE NOTE A AND B | |
| 11 | 10 | 60170 | SCREW, FLANGE TO PROPELL | ,,2,2 | SEE NOTE A AND B | |
| 11 | 10 | 60169 | SCREW, FLANGE TO PROPELL | 2,2,2, | SEE NOTE A AND B | |
| 12 | 10 | 37909 | SCREW, FLANGE TO TRANSMI | 4,4,4,, | | |
| 13 | 13 | 35048 | LOCKWASHER, TRANSMISSIOI | 4,4,4,, | | |
| 14 | 11 | 24883 | NUT, TRANSMISSION FLANGE | 4,4,4,, | | |
| 15 | 22 | 63824 | ELBOW, HOSE TO TRANSMISSIC | ,1,1,1,1 | | |
| 16 | | 48648 | BRACKET, SHIFT CABLE (SERIAL | 1,1,1,1, | | |
| 16 | | 63815A 1 | BRACKET, SHIFT CABLE (SERIAL | 1,1,1,1, | | |
| 17 | 12 | 37407 | WASHER, SHIFT CABLE TO BRA | 1,1,1,1, | | |
| 18 | 11 | 46438 | NUT, SHIFT CALBE TO BRACKET | 1,1,1,1, | | |
| 19 | 10 | 35585 | SCREW, BRACKET TO TRANSMI | 2,2,2,2, | | |
| 20 | 13 | 26392 | LOCKWASHER, BRACKET SCREW | 2,2,2,2, | | |
| 21 | | 48515 | LEVER, SHIFT TRANSMISSION | 1,1,1,1, | | |