



## 2-BLADE FOLDING PROPELLER

Available for both sail drive and shaft. Propeller size has to be calculated to match engine and gear ratio. Use calculation program or propeller diagrams. For a complete propeller, order one blade kit and one hub kit.

BLADE KITS*	S-DRIVE & SHAFT	SHAFT
Ø x PITCH		
14 x 7	21629132	21629136
14 x 8	21629140	21629144
15 x 8	21629147	21629152
15 x 10	21629158	21629167
16 x 10	21629173	21629177
16 x 11	21629182	21629186
17 x 11	21629190	21629194
17 x 12	21629198	21629201
18 x 12	21629205	21629211
19 x 13	21629214	21629218

Propeller size has to be calculated to match engine and gear ratio. Use calculation program or propeller diagrams.



HUB KITS FOR 2-BLADE FOLDING PROPELLER *					
S-DRIVE	SHAFT				
<b>S-drive 120/130/S MS25S, 150S</b> 21630720	<b>Shaft 25 mm</b> Taper 1:10 Key 6 mm 21630721	<b>Shaft 30 mm</b> Taper 1:10 Key 8 mm 21630722	<b>Shaft 1 1/4"</b> Taper 1:16 Key 5/16 21630724	<b>Shaft 1"</b> Taper 1:16 Key 1/4 21630723	<b>HUB KIT</b> Pre-drilled, 21630725

\* For a complete propeller, order one blade kit and one hub kit.

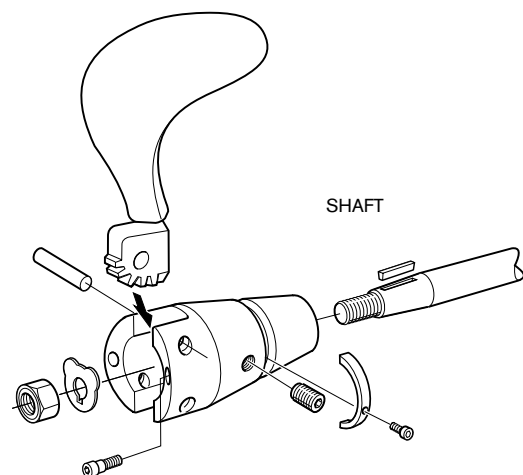
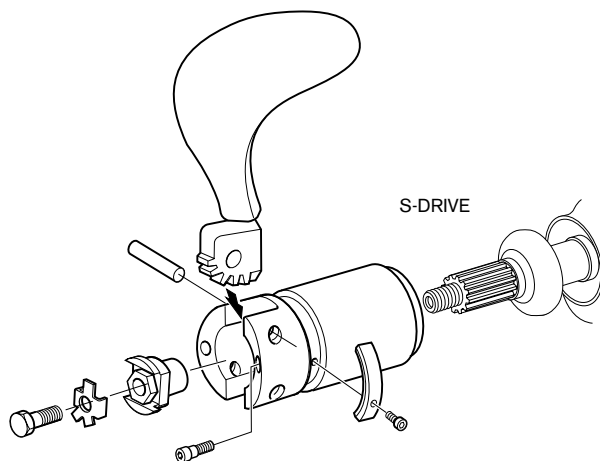

### ACCESSORIES 2-BLADE FOLDING

Part No	Qty	Description
3584466	1	Propeller nut
3851994	1	Lock washer
946730	1	Hexagon screw
21626924	2	Shaft
3595221	2	Lock screw
3581246	2	Screw
3858399	1	Zinc anode kit S-drive
3858400	1	Magnesium anode kit S-drive
963677	3	Hex. socket screw

Part No	Qty	Description
3888491	1	Anode kit Shaft
3888493	1	Anode kit Shaft
963675	2	Hex. socket screw
1161053	1	Locking fluid
828250	1	Lubricating grease 25g
21347121	1	Grease, propeller shaft 400ml
873475	1	Tab washer
873473	1	Nut
873474	1	Key